



# 1/4" Drive Impact Hex Drivers



## No. 9298HC 1/4" Drive Fractional & Metric Hex Driver Set



14 piece set contents:



9904F	.....	1/8"	9902M	.....	.2mm
9905F	.....	5/32" / 4mm	9925M	.....	2.5mm
9906F	.....	3/16"	9903M	.....	.3mm
9907F	.....	7/32"	9905M	.....	.5mm
9908F	.....	1/4"	9906M	.....	.6mm
9910F	.....	5/16" / 8mm	9907M	.....	.7mm
9912F	.....	3/8"	9910M	.....	.10mm

Molded Storage Case



## 1/4" Drive Fractional Hex Drivers



One piece impact hex drivers in fractional sizes.



Item Number	Hex Size	Dimensions (Inches)			
		A	C	D	E
<b>9904F</b>	<b>1/8"</b>	.51	.83	.24	1.38
<b>9905F</b>	<b>5/32"</b>	.51	.83	.24	1.38
<b>9906F</b>	<b>3/16"</b>	.51	.83	.24	1.38
<b>9907F</b>	<b>7/32"</b>	.51	.83	.24	1.38
<b>9908F</b>	<b>1/4"</b>	.51	.83	.24	1.38
<b>9910F</b>	<b>5/16"</b>	.51	.83	.31	1.38
<b>9912F</b>	<b>3/8"</b>	.51	.83	.39	1.38

HEX



## 1/4" Drive Metric Hex Drivers



One piece impact hex drivers in metric sizes.

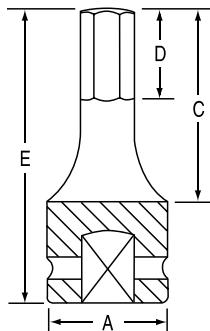

Item Number	Hex Size	Dimensions (Millimeters)			
		A	C	D	E
<b>9902M</b>	<b>2mm</b>	13	21	4	35
<b>9925M</b>	<b>2.5mm</b>	13	21	4	35
<b>9903M</b>	<b>3mm</b>	13	21	6	35
<b>9904M</b>	<b>4mm</b>	13	21	6	35
<b>9905M</b>	<b>5mm</b>	13	21	6	35
<b>9906M</b>	<b>6mm</b>	13	21	6	35
<b>9907M</b>	<b>7mm</b>	13	21	8	35
<b>9908M</b>	<b>8mm</b>	13	21	8	35
<b>9909M</b>	<b>9mm</b>	13	21	10	35
<b>9910M</b>	<b>10mm</b>	13	21	10	35





# 3/8" Drive Impact Hex Driver Sets



## Hex No. 1298HC 3/8" Drive Fractional & Metric Hex Driver Set SAE MM



### 13 piece set contents:

1906F	.....	3/16"	1904M	.....	.4mm
1907F	.....	7/32"	1905M	.....	.5mm
1908F	.....	1/4"	1906M	.....	.6mm
1910F	.....	.5/16"/8mm	1907M	.....	.7mm
1912F	.....	3/8"	1910M	.....	10mm
1914F	.....	7/16"	1912M	.....	12mm
1916F	.....	1/2"			Molded Storage Case



## Hex No. 1297H 3/8" Drive Fractional Hex Driver Set SAE



### 7 piece set contents:

1906F	.....	3/16"	1912F	.....	3/8"
1907F	.....	7/32"	1914F	.....	7/16"
1908F	.....	1/4"	1916F	.....	1/2"
1910F	.....	5/16"			Molded Storage Case

## Hex No. 1297MH 3/8" Drive Metric Hex Driver Set MM



### 7 piece set contents:

1904M	.....	.4mm	1908M	.....	.8mm
1905M	.....	.5mm	1910M	.....	10mm
1906M	.....	.6mm	1912M	.....	12mm
1907M	.....	.7mm			Molded Storage Case



# 3/8" Drive Impact Hex Drivers



## 3/8" Drive Fractional Hex Drivers



One piece impact hex drivers in fractional sizes.



Item Number	Hex Size	Dimensions (Inches)			
		A	C	D	E
<b>1906F</b>	<b>3/16"</b>	.75	1.22	.63	1.97
<b>1907F</b>	<b>7/32"</b>	.75	1.22	.63	1.97
<b>1908F</b>	<b>1/4"</b>	.75	1.22	.63	1.97
<b>1909F</b>	<b>9/32"</b>	.75	1.22	.63	1.97
<b>1910F</b>	<b>5/16"</b>	.75	1.22	.63	1.97
<b>1912F</b>	<b>3/8"</b>	.75	1.22	.63	1.97
<b>1914F</b>	<b>7/16"</b>	.75	1.22	.63	1.97
<b>1916F</b>	<b>1/2"</b>	.75	1.22	.63	1.97



## 3/8" Drive Metric Hex Drivers



HEX

One piece impact hex drivers in metric sizes.

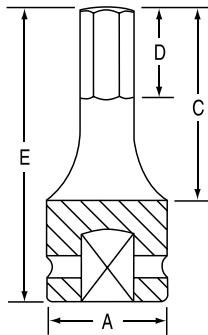

Item Number	Hex Size	Dimensions (Millimeters)			
		A	C	D	E
<b>1904M</b>	<b>4mm</b>	19	31	12	50
<b>1905M</b>	<b>5mm</b>	19	31	12	50
<b>1906M</b>	<b>6mm</b>	19	31	12	50
<b>1907M</b>	<b>7mm</b>	19	31	16	50
<b>1908M</b>	<b>8mm</b>	19	31	16	50
<b>1909M</b>	<b>9mm</b>	19	31	16	50
<b>1910M</b>	<b>10mm</b>	19	31	16	50
<b>1911M</b>	<b>11mm</b>	19	31	16	50
<b>1912M</b>	<b>12mm</b>	19	31	16	50



# 3/8" Drive Extended Length Impact Hex Driver Sets



## Hex No. 1247H 3/8" Drive - 4" Length - Fractional Hex Driver Set SAE



**4" Length**

### 7 piece set contents:

19064F . . . . . 3/16"	19124F . . . . . 3/8"
19074F . . . . . 7/32"	19144F . . . . . 7/16"
19084F . . . . . 1/4"	19164F . . . . . 1/2"
19104F . . . . . 5/16"	on a Metal Clip Rail

## Hex No. 1267H 3/8" Drive - 6" Length - Fractional Hex Driver Set SAE



**6" Length**

### 7 piece set contents:

19066F . . . . . 3/16"	19126F . . . . . 3/8"
19076F . . . . . 7/32"	19146F . . . . . 7/16"
19086F . . . . . 1/4"	19166F . . . . . 1/2"
19106F . . . . . 5/16"	on a Metal Clip Rail

## Hex No. 1247MH 3/8" Drive - 4" Length - Metric Hex Driver Set MM



**4" Length**

### 7 piece set contents:

19044M . . . . . 4mm	19084M . . . . . 8mm
19054M . . . . . 5mm	19104M . . . . . 10mm
19064M . . . . . 6mm	19124M . . . . . 12mm
19074M . . . . . 7mm	on a Metal Clip Rail

## Hex No. 1267MH 3/8" Drive - 6" Length - Metric Hex Driver Set MM



**6" Length**

### 7 piece set contents:

19046M . . . . . 4mm	19086M . . . . . 8mm
19056M . . . . . 5mm	19106M . . . . . 10mm
19066M . . . . . 6mm	19126M . . . . . 12mm
19076M . . . . . 7mm	on a Metal Clip Rail

HEX



# 3/8" Drive - 4" Length Impact Hex Drivers



## Hex 3/8" Drive - 4" Length - Fractional Hex Drivers SAE

One piece impact hex drivers in fractional sizes. 4" extended length for special applications.



Item Number	Hex Size	Dimensions (Inches)			
		A	C	D	E
<b>19064F</b>	<b>3/16"</b>	.75	3.23	.43	3.94
<b>19074F</b>	<b>7/32"</b>	.75	3.23	.43	3.94
<b>19084F</b>	<b>1/4"</b>	.75	3.23	.43	3.94
<b>19094F</b>	<b>9/32"</b>	.75	3.23	.43	3.94
<b>19104F</b>	<b>5/16"</b>	.75	3.23	.63	3.94
<b>19124F</b>	<b>3/8"</b>	.75	3.23	.63	3.94
<b>19144F</b>	<b>7/16"</b>	.75	3.23	.63	3.94
<b>19164F</b>	<b>1/2"</b>	.75	3.23	.63	3.94

## Hex 3/8" Drive - 4" Length - Metric Hex Drivers MM

One piece impact hex drivers in metric sizes. 4" extended length for special applications.

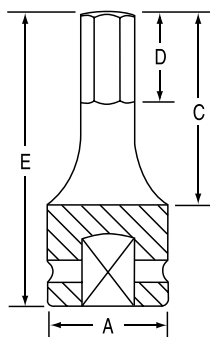

Item Number	Hex Size	Dimensions (Millimeters)			
		A	C	D	E
<b>19044M</b>	<b>4mm</b>	19	82	11	100
<b>19054M</b>	<b>5mm</b>	19	82	11	100
<b>19064M</b>	<b>6mm</b>	19	82	11	100
<b>19074M</b>	<b>7mm</b>	19	82	16	100
<b>19084M</b>	<b>8mm</b>	19	82	16	100
<b>19094M</b>	<b>9mm</b>	19	82	16	100
<b>19104M</b>	<b>10mm</b>	19	82	16	100
<b>19114M</b>	<b>11mm</b>	19	82	16	100
<b>19124M</b>	<b>12mm</b>	19	82	16	100



# 3/8" Drive - 6" Length Impact Hex Drivers



## Hex 3/8" Drive - 6" Length - Fractional Hex Drivers SAE

One piece impact hex drivers in fractional sizes. 6" extended length for special applications.

Item Number	Hex Size	Dimensions (Inches)			
		A	C	D	E
<b>19066F</b>	<b>3/16"</b>	.75	5.24	.43	5.91
<b>19076F</b>	<b>7/32"</b>	.75	5.24	.43	5.91
<b>19086F</b>	<b>1/4"</b>	.75	5.24	.43	5.91
<b>19096F</b>	<b>9/32"</b>	.75	5.24	.43	5.91
<b>19106F</b>	<b>5/16"</b>	.75	5.24	.63	5.91
<b>19126F</b>	<b>3/8"</b>	.75	5.24	.63	5.91
<b>19146F</b>	<b>7/16"</b>	.75	5.24	.63	5.91
<b>19166F</b>	<b>1/2"</b>	.75	5.24	.63	5.91

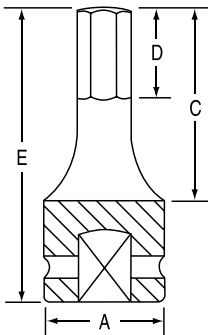

## Hex 3/8" Drive - 6" Length - Metric Hex Drivers MM

One piece impact hex drivers in metric sizes. 6" extended length for special applications.

Item Number	Hex Size	Dimensions (Millimeters)			
		A	C	D	E
<b>19046M</b>	<b>4mm</b>	19	133	11	150
<b>19056M</b>	<b>5mm</b>	19	133	11	150
<b>19066M</b>	<b>6mm</b>	19	133	11	150
<b>19076M</b>	<b>7mm</b>	19	133	16	150
<b>19086M</b>	<b>8mm</b>	19	133	16	150
<b>19096M</b>	<b>9mm</b>	19	133	16	150
<b>19106M</b>	<b>10mm</b>	19	133	16	150
<b>19116M</b>	<b>11mm</b>	19	133	16	150
<b>19126M</b>	<b>12mm</b>	19	133	16	150

HEX



# 1/2" Drive Impact Hex Driver Sets



## Hex No. 1598HC 1/2" Drive Fractional & Metric Hex Driver Set SAE MM



### 18 piece set contents:

2908F	.....	1/4"	2906M	.....	.6mm
2909F	.....	9/32"	2907M	.....	.7mm
2910F	.....	5/16"/8mm	2910M	.....	10mm
2912F	.....	3/8"	2912M	.....	12mm
2914F	.....	7/16"	2914M	.....	14mm
2916F	.....	1/2"	2915M	.....	15mm
2918F	.....	9/16"	2917M	.....	17mm
2920F	.....	5/8"/16mm	2918M	.....	18mm
2922F	.....	11/16"			Molded Storage Case
2924F	.....	3/4"/19mm			

## Hex No. 1398H 1/2" Drive Fractional Hex Driver Set SAE



### 10 piece set contents:

2908F	.....	1/4"	2916F	.....	1/2"
2909F	.....	9/32"	2918F	.....	9/16"
2910F	.....	5/16"	2920F	.....	5/8"
2912F	.....	3/8"	2922F	.....	11/16"
2914F	.....	7/16"	2924F	.....	3/4"
					Molded Storage Case

## Hex No. 1498MH 1/2" Drive Metric Hex Driver Set MM



### 10 piece set contents:

2906M	.....	.6mm	2914M	.....	14mm
2907M	.....	.7mm	2915M	.....	15mm
2908M	.....	.8mm	2917M	.....	17mm
2910M	.....	10mm	2918M	.....	18mm
2912M	.....	12mm	2919M	.....	19mm
					Molded Storage Case

HEX



# 1/2" Drive Impact Hex Drivers



## Hex 1/2" Drive Fractional Hex Drivers SAE

One piece impact hex drivers in fractional sizes.



Item Number	Hex Size	Dimensions (Inches)			
		A	C	D	E
<b>2908F</b>	<b>1/4"</b>	.98	2.01	.59	2.95
<b>2909F</b>	<b>9/32"</b>	.98	2.01	.79	2.95
<b>2910F</b>	<b>5/16"</b>	.98	2.01	.98	2.95
<b>2912F</b>	<b>3/8"</b>	.98	2.01	.98	2.95
<b>2914F</b>	<b>7/16"</b>	.98	2.01	.98	2.95
<b>2916F</b>	<b>1/2"</b>	.98	2.01	.98	2.95
<b>2918F</b>	<b>9/16"</b>	.98	2.01	.98	2.95
<b>2920F</b>	<b>5/8"</b>	.98	2.01	.98	2.95
<b>2922F</b>	<b>11/16"</b>	.98	2.01	.98	2.95
<b>2924F</b>	<b>3/4"</b>	.98	2.01	.98	2.95

HEX

## Hex 1/2" Drive Metric Hex Drivers MM

One piece impact hex drivers in metric sizes.

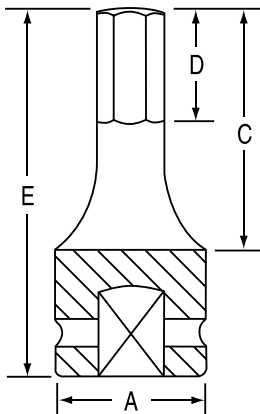

Item Number	Hex Size	Dimensions (Millimeters)			
		A	C	D	E
<b>2906M</b>	<b>6mm</b>	25	51	15	75
<b>2907M</b>	<b>7mm</b>	25	51	20	75
<b>2908M</b>	<b>8mm</b>	25	51	25	75
<b>2909M</b>	<b>9mm</b>	25	51	25	75
<b>2910M</b>	<b>10mm</b>	25	51	25	75
<b>2911M</b>	<b>11mm</b>	25	51	25	75
<b>2912M</b>	<b>12mm</b>	25	51	25	75
<b>2913M</b>	<b>13mm</b>	25	51	25	75
<b>2914M</b>	<b>14mm</b>	25	51	25	75
<b>2915M</b>	<b>15mm</b>	25	51	25	75
<b>2916M</b>	<b>16mm</b>	25	51	25	75
<b>2917M</b>	<b>17mm</b>	25	51	25	75
<b>2918M</b>	<b>18mm</b>	25	51	25	75
<b>2919M</b>	<b>19mm</b>	25	51	25	75





# 1/2" Drive Extended Length Impact Hex Driver Sets



## No. 1340H 1/2" Drive - 4" Length - Fractional Hex Driver Set SAE



4" Length

### 10 piece set contents:

29084F..... 1/4"	29164F..... 1/2"
29094F..... 9/32"	29184F..... 9/16"
29104F..... 5/16"	29204F..... 5/8"
29124F..... 3/8"	29224F..... 11/16"
29144F..... 7/16"	29244F..... 3/4"

on a Metal Clip Rail



## No. 1360H 1/2" Drive - 6" Length - Fractional Hex Driver Set SAE



6" Length

### 10 piece set contents:

29086F..... 1/4"	29166F..... 1/2"
29096F..... 9/32"	29186F..... 9/16"
29106F..... 5/16"	29206F..... 5/8"
29126F..... 3/8"	29226F..... 11/16"
29146F..... 7/16"	29246F..... 3/4"

on a Metal Clip Rail



## No. 1343MH 1/2" Drive - 4" Length - Metric Hex Driver Set MM



4" Length

### 13 piece set contents:

29064M..... .6mm	29144M..... .14mm
29074M..... .7mm	29154M..... .15mm
29084M..... .8mm	29164M..... .16mm
29104M..... .10mm	29174M..... .17mm
29114M..... .11mm	29184M..... .18mm
29124M..... .12mm	29194M..... .19mm
29134M..... .13mm	

on a Metal Clip Rail



## No. 1363MH 1/2" Drive - 6" Length - Metric Hex Driver Set MM



6" Length

### 13 piece set contents:

29066M..... .6mm	29146M..... .14mm
29076M..... .7mm	29156M..... .15mm
29086M..... .8mm	29166M..... .16mm
29106M..... .10mm	29176M..... .17mm
29116M..... .11mm	29186M..... .18mm
29126M..... .12mm	29196M..... .19mm
29136M..... .13mm	

on a Metal Clip Rail

HEX





# 1/2" Drive - 4" Length Impact Hex Drivers



## Hex 1/2" Drive - 4" Length - Fractional Hex Drivers SAE

One piece impact hex drivers in fractional sizes. 4" extended length for special applications.



Item Number	Hex Size	Dimensions (Inches)			
		A	C	D	E
<b>29084F</b>	<b>1/4"</b>	.98	2.95	.59	3.94
<b>29094F</b>	<b>9/32"</b>	.98	2.95	.79	3.94
<b>29104F</b>	<b>5/16"</b>	.98	2.95	.98	3.94
<b>29124F</b>	<b>3/8"</b>	.98	2.95	.98	3.94
<b>29144F</b>	<b>7/16"</b>	.98	2.95	.98	3.94
<b>29164F</b>	<b>1/2"</b>	.98	2.95	.98	3.94
<b>29184F</b>	<b>9/16"</b>	1.18	2.95	.98	3.94
<b>29204F</b>	<b>5/8"</b>	1.18	2.95	.98	3.94
<b>29224F</b>	<b>11/16"</b>	1.18	2.95	.98	3.94
<b>29244F</b>	<b>3/4"</b>	1.18	2.95	.98	3.94

HEX

## Hex 1/2" Drive - 4" Length - Metric Hex Drivers MM

One piece impact hex drivers in metric sizes. 4" extended length for special applications.

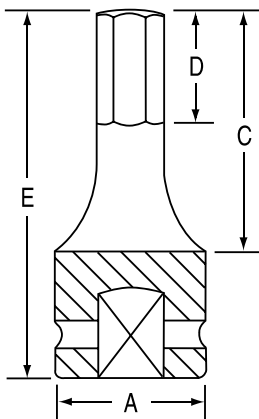

Item Number	Hex Size	Dimensions (Millimeters)			
		A	C	D	E
<b>29064M</b>	<b>6mm</b>	25	75	15	100
<b>29074M</b>	<b>7mm</b>	25	75	20	100
<b>29084M</b>	<b>8mm</b>	25	75	25	100
<b>29094M</b>	<b>9mm</b>	25	75	25	100
<b>29104M</b>	<b>10mm</b>	25	75	25	100
<b>29114M</b>	<b>11mm</b>	25	75	25	100
<b>29124M</b>	<b>12mm</b>	25	75	25	100
<b>29134M</b>	<b>13mm</b>	25	75	25	100
<b>29144M</b>	<b>14mm</b>	30	75	25	100
<b>29154M</b>	<b>15mm</b>	30	75	25	100
<b>29164M</b>	<b>16mm</b>	30	75	25	100
<b>29174M</b>	<b>17mm</b>	30	75	25	100
<b>29184M</b>	<b>18mm</b>	30	75	25	100
<b>29194M</b>	<b>19mm</b>	30	75	25	100



# 1/2" Drive - 6" Length Impact Hex Drivers



## Hex 1/2" Drive - 6" Length - Fractional Hex Drivers SAE

One piece impact hex drivers in fractional sizes. 6" extended length for special applications.



Item Number	Hex Size	Dimensions (Inches)			
		A	C	D	E
<b>29086F</b>	<b>1/4"</b>	.98	4.88	.59	5.91
<b>29096F</b>	<b>9/32"</b>	.98	4.88	.79	5.91
<b>29106F</b>	<b>5/16"</b>	.98	4.88	.98	5.91
<b>29126F</b>	<b>3/8"</b>	.98	4.88	.98	5.91
<b>29146F</b>	<b>7/16"</b>	.98	4.88	.98	5.91
<b>29166F</b>	<b>1/2"</b>	.98	4.88	.98	5.91
<b>29186F</b>	<b>9/16"</b>	.98	4.88	.98	5.91
<b>29206F</b>	<b>5/8"</b>	.98	4.88	.98	5.91
<b>29226F</b>	<b>11/16"</b>	.98	4.88	.98	5.91
<b>29246F</b>	<b>3/4"</b>	.98	4.88	.98	5.91

## Hex 1/2" Drive - 6" Length - Metric Hex Drivers MM

One piece impact hex drivers in metric sizes. 6" extended length for special applications.

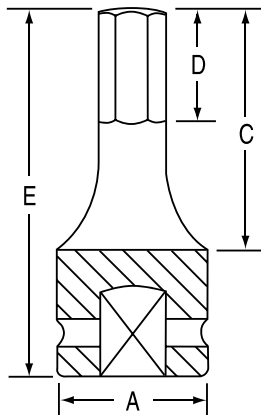

Item Number	Hex Size	Dimensions (Millimeters)			
		A	C	D	E
<b>29066M</b>	<b>6mm</b>	25	124	15	150
<b>29076M</b>	<b>7mm</b>	25	124	20	150
<b>29086M</b>	<b>8mm</b>	25	124	25	150
<b>29096M</b>	<b>9mm</b>	25	124	25	150
<b>29106M</b>	<b>10mm</b>	25	124	25	150
<b>29116M</b>	<b>11mm</b>	25	124	25	150
<b>29126M</b>	<b>12mm</b>	25	124	25	150
<b>29136M</b>	<b>13mm</b>	25	124	25	150
<b>29146M</b>	<b>14mm</b>	25	124	25	150
<b>29156M</b>	<b>15mm</b>	25	124	25	150
<b>29166M</b>	<b>16mm</b>	25	124	25	150
<b>29176M</b>	<b>17mm</b>	25	124	25	150
<b>29186M</b>	<b>18mm</b>	25	124	25	150
<b>29196M</b>	<b>19mm</b>	25	124	25	150



# 1/2" Drive Universal Impact Hex Drivers



## Hex No. 1398UH 1/2" Drive Fractional Universal Hex Driver Set SAE



8 piece set contents:

2908UF . . . . . 1/4"	2916UF . . . . . 1/2"
2910UF . . . . . 5/16"	2918UF . . . . . 9/16"
2912UF . . . . . 3/8"	2920UF . . . . . 5/8"
2914UF . . . . . 7/16"	2924UF . . . . . 3/4"

Molded Storage Case

## Hex No. 1499UMH 1/2" Drive Metric Universal Hex Driver Set MM



9 piece set contents:

2906UM . . . . . 6mm	2915UM . . . . . 15mm
2908UM . . . . . 8mm	2917UM . . . . . 17mm
2910UM . . . . . 10mm	2918UM . . . . . 18mm
2912UM . . . . . 12mm	2919UM . . . . . 19mm
2914UM . . . . . 14mm	

Molded Storage Case

## Hex 1/2" Drive Universal Hex Drivers SAE MM

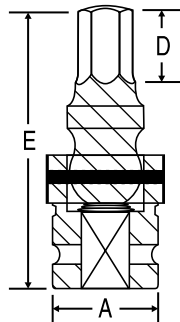

Item Number	Hex Size	Dimensions (Inches/Millimeters)		
		A	D	E
<b>Fractional Sizes</b>				
<b>2908UF</b>	<b>1/4"</b>	1.10	.51	2.95
<b>2910UF</b>	<b>5/16"</b>	1.10	.79	2.95
<b>2912UF</b>	<b>3/8"</b>	1.10	.79	2.95
<b>2914UF</b>	<b>7/16"</b>	1.10	.79	2.95
<b>2916UF</b>	<b>1/2"</b>	1.10	.79	2.95
<b>2918UF</b>	<b>9/16"</b>	1.10	.79	2.95
<b>2920UF</b>	<b>5/8"</b>	1.10	.79	2.95
<b>2924UF</b>	<b>3/4"</b>	1.10	.79	2.95
<b>Metric Sizes</b>				
<b>2906UM</b>	<b>6mm</b>	28	13	75
<b>2908UM</b>	<b>8mm</b>	28	20	75
<b>2910UM</b>	<b>10mm</b>	28	20	75
<b>2912UM</b>	<b>12mm</b>	28	20	75
<b>2914UM</b>	<b>14mm</b>	28	20	75
<b>2915UM</b>	<b>15mm</b>	28	20	75
<b>2917UM</b>	<b>17mm</b>	28	20	75
<b>2918UM</b>	<b>18mm</b>	28	20	75
<b>2919UM</b>	<b>19mm</b>	28	20	75



# 3/4" Drive Impact Hex Drivers



No. 8096H

3/4" Drive Fractional Hex Driver Set



6 piece set contents:

3916F .....	1/2"	3924F .....	3/4"
3918F .....	9/16"	3928F .....	7/8"
3920F .....	5/8"	3932F .....	1"
			Molded Storage Case



No. 8196MH

3/4" Drive Metric Hex Driver Set



6 piece set contents:

3912M .....	12mm	3922M .....	22mm
3914M .....	14mm	3924M .....	24mm
3917M .....	17mm		Molded Storage Case
3919M .....	19mm		



3/4" Drive Hex Drivers

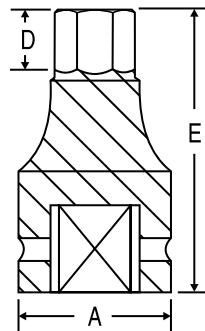

Item Number	Hex Size	Dimensions (Inches)		
		A	D	E
<b>Fractional Sizes</b>				
<b>3916F</b>	<b>1/2"</b>	1.73	.79	3.94
<b>3918F</b>	<b>9/16"</b>	1.73	.79	3.94
<b>3920F</b>	<b>5/8"</b>	1.73	.79	3.94
<b>3924F</b>	<b>3/4"</b>	1.73	.79	3.94
<b>3926F</b>	<b>13/16"</b>	1.73	.79	3.94
<b>3928F</b>	<b>7/8"</b>	1.73	.79	3.94
<b>3932F</b>	<b>1"</b>	1.73	.79	3.94
<b>3934F</b>	<b>1-1/16"</b>	1.73	.79	3.94
<b>3936F</b>	<b>1-1/8"</b>	1.73	.79	3.94
<b>3938F</b>	<b>1-3/16"</b>	1.73	.79	3.94
<b>3940F</b>	<b>1-1/4"</b>	1.73	.79	3.94
<b>Metric Sizes</b>				
<b>3912M</b>	<b>12mm</b>	1.73	.79	3.94
<b>3914M</b>	<b>14mm</b>	1.73	.79	3.94
<b>3917M</b>	<b>17mm</b>	1.73	.79	3.94
<b>3919M</b>	<b>19mm</b>	1.73	.79	3.94
<b>3922M</b>	<b>22mm</b>	1.73	.79	3.94
<b>3924M</b>	<b>24mm</b>	1.73	.79	3.94
<b>3927M</b>	<b>27mm</b>	1.73	.79	3.94
<b>3930M</b>	<b>30mm</b>	1.73	.79	3.94

HEX





# 1" Drive Impact Hex Drivers



## Hex No. 9096H 1" Drive Fractional Hex Driver Set SAE



6 piece set contents:

4924F	3/4"	4936F	1-1/8"
4928F	7/8"	4940F	1-1/4"
4932F	1"	4944F	1-3/8"

Molded Storage Case

## Hex No. 9196MH 1" Drive Metric Hex Driver Set MM



6 piece set contents:

4914M	14mm	4922M	22mm
4917M	17mm	4924M	24mm
4919M	19mm	4927M	27mm

Molded Storage Case

## Hex 1" Drive Hex Drivers SAE MM

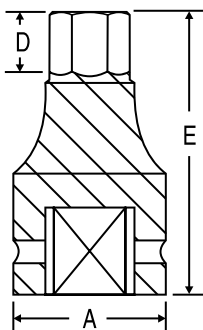

Item Number	Hex Size	Dimensions (Inches/Millimeters)		
		A	D	E
<b>Fractional Sizes</b>				
4920F	5/8"	2.13	.79	3.94
4924F	3/4"	2.13	.79	3.94
4926F	13/16"	2.13	.79	3.94
4928F	7/8"	2.13	.79	3.94
4932F	1"	2.13	.79	3.94
4934F	1-1/16"	2.13	.79	3.94
4936F	1-1/8"	2.13	.79	3.94
4938F	1-3/16"	2.13	.79	3.94
4940F	1-1/4"	2.13	.79	3.94
4942F	1-5/16"	2.13	.79	3.94
4944F	1-3/8"	2.13	.79	3.94
4948F	1-1/2"	2.13	.79	3.94
4952F	1-5/8"	2.13	.79	3.94
4956F	1-3/4"	2.13	.79	3.94

<b>Metric Sizes</b>				
4914M	14mm	54	20	100
4917M	17mm	54	20	100
4919M	19mm	54	20	100
4922M	22mm	54	20	100
4924M	24mm	54	20	100
4927M	27mm	54	20	100
4930M	30mm	54	20	100
4933M	33mm	54	20	100
4936M	36mm	54	20	100
4938M	38mm	54	20	100
4941M	41mm	54	20	100



# 1-1/2" Drive Impact Hex Drivers



## 1-1/2" Drive Fractional Hex Drivers



One piece impact hex drivers in fractional sizes.



Item Number	Hex Size	Dimensions (Inches)		
		A	D	E
6924F	3/4"	3.39	.79	4.72
6926F	13/16"	3.39	.79	4.72
6928F	7/8"	3.39	.79	4.72
6930F	15/16"	3.39	.79	4.72
6932F	1"	3.39	.79	4.72
6934F	1-1/16"	3.39	.79	4.72
6936F	1-1/8"	3.39	.79	4.72
6938F	1-3/16"	3.39	.79	4.72
6940F	1-1/4"	3.39	.79	4.72
6942F	1-5/16"	3.39	.79	4.72
6944F	1-3/8"	3.39	.79	4.72
6948F	1-1/2"	3.39	.79	4.72
6952F	1-5/8"	3.39	.79	4.72
6956F	1-3/4"	3.39	.79	4.72
6958F	1-13/16"	3.39	.79	4.72
6964F	2"	3.39	.79	4.72
6968F	2-1/8"	3.39	.79	4.72
6970F	2-3/16"	3.39	.79	4.72



## 1-1/2" Drive Metric Hex Drivers



HEX

One piece impact hex drivers in metric sizes.

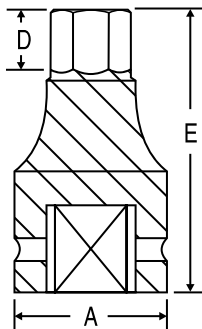

Item Number	Hex Size	Dimensions (Millimeters)		
		A	D	E
6919M	19mm	86	20	120
6922M	22mm	86	20	120
6924M	24mm	86	20	120
6927M	27mm	86	20	120
6930M	30mm	86	20	120
6932M	32mm	86	20	120
6933M	33mm	86	20	120
6936M	36mm	86	20	120
6938M	38mm	86	20	120
6941M	41mm	86	20	120
6946M	46mm	86	20	120
6950M	50mm	86	20	120
6955M	55mm	86	20	120



**WARNING:** Always wear safety goggles when using Impact Tools. Use only properly matched fractional or metric sizes.

